



AS 1428
IS ACCESS ENOUGH?
THE BUILDING CODE OF AUSTRALIA DOES NOT SET THE
MINIMUM STANDARDS FOR ACCESSIBILITY OF BUILDINGS
TO PEOPLE WITH DISABILITIES. ACCESS TO ALL AREAS
SHOULD BE EASY. ACCESS TO ALL AREAS
SHOULD BE EASY.
AS 1428
THIS AUSTRALIAN STANDARD OUTLINES A
SYSTEM OF REQUIREMENTS FOR ACCESSIBILITY.
IN SPITE OF THE MANY PROGRESSIVE AND
INCLUSIVE DESIGN SOLUTIONS AVAILABLE TO FEEL
WELCOMED AND VALUED IN OUR SPACES.
EXPLORE THE FLEXIBILITY OF OUR OPTIONS.

AS 1428

AS 1428

WITHIN A DISABLED HOUSEHOLD, DISCUSSIONS AND OBSERVATIONS CONSTANTLY OCCUR REGARDING HEALTH, DESIGN, AND GENERAL SOCIETAL NORMS SURROUNDING THESE INTERESTS

WHEN BROADENING THE SCOPE OF STUDY FROM THIS MICRO PERSPECTIVE TO A MACRO SCALE, SUCH AS AUSTRALIA, THE BOUNDARIES PLACED UPON PERSONS WITH DISABILITIES GO BEYOND SOCIAL OR CULTURAL MEANS

AS DESIGNERS ENTERING A FIELD DURING THE 21ST CENTURY, IT IS AN OBLIGATION TO DESIGN FOR EVERYONE HOWEVER, ONES CONCIOSNESS SURROUNDING INCLUSIVITY & ACCESSIBILITY SOMETIMES JUST ISN'T ENOUGH

THE REALITIES OF DESIGN GO FURTHER THAN THIS

THE INTRODUCTION OF THE BUILDING CODE OF AUSTRALIA (BCA) AND THE DISABILITY STANDARDS (PREMISES STANDARDS),

AS1428 WAS DEVELOPED TO ENSURE

1. CONTINUOUS ACCESSIBLE PATHS OF TRAVEL AND CIRCULATION SPACES FOR PEOPLE WHO USE WHEELCHAIRS;

2. ACCESS AND FACILITIES FOR PEOPLE WITH AMBULATORY DISABILITIES; AND

3. ACCESS FOR PEOPLE WITH SENSORY DISABILITIES.

IS ACCESS ENOUGH?

OBSERVATIONAL STUDY

GROUP DISCUSSION

THESE STANDARDS TRULY ARE THE MINIMUM

One member of the discussion, who works at a major rural hospital in the Northern Rivers, commented on new renovations that were completed on her ward in 2022. Whilst the hospital was aesthetically contemporary & clean, the distance between permanent beds and walls, whilst meeting the minimum standards as outlined in AS1428, were unable to move the hospitals standard wheelchairs.

Posing a MAJOR medical risk & endangering regular members of the public

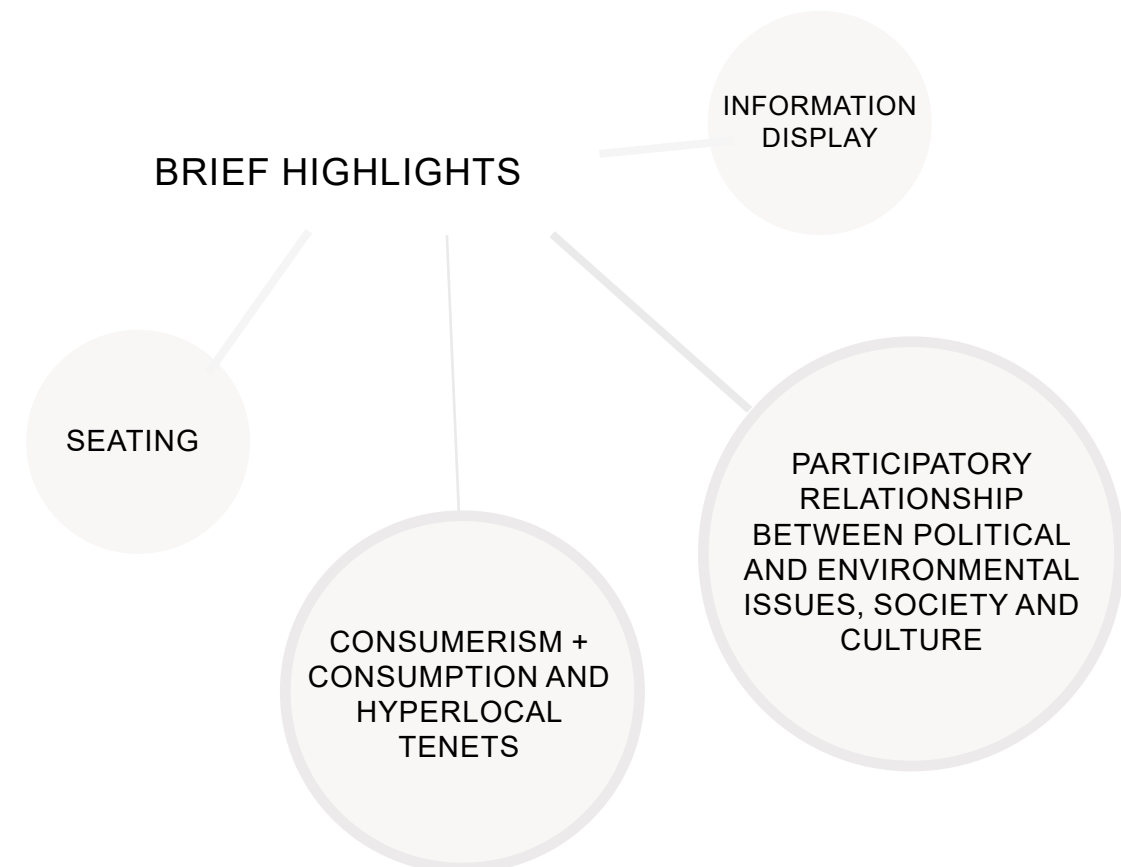



GOMA WATERMALL

Observation of this space saw a regular, but quiet, flow of pedestrians. This is an attractive aspect of the space when considering our intended audience & stakeholders.

This site also sees a beautiful, natural light, removing the necessity for excessive electrical work for the project as lighting is able to be exclusively provided with LED, remote-controlled lighting components. The exposed & open ceiling design allows for this.



MONTE LUPO ARTS

Monte Lupu Arts provides employment, passion and joy for its employees, primarily persons with disabilities.

These products will be featured and sold within the store hub, using a portable POS system. Variation in size, price and aesthetic appeal allows for these unique products to inspire and connect the audience with the cause, further contributing to AS 1428's installation intention; connection & understanding.

FLOORPLANS

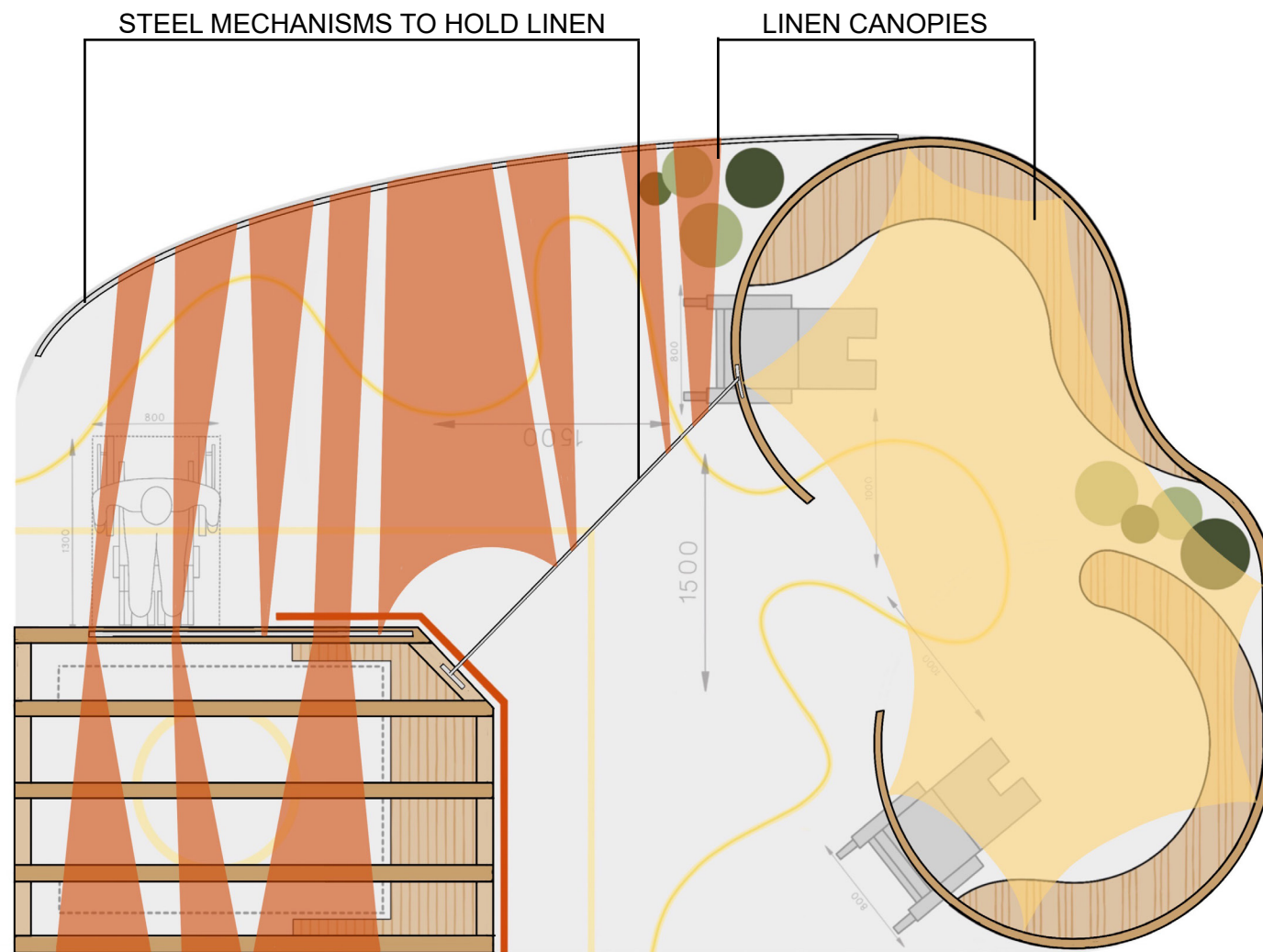

CEILING PLAN 1:50

The intention of the sheer, linen canopies is to communicate the flexibility that is a necessity for disabilities and therefore accessibility; the difference in colour and tension applied communicate this concept.

Due to the utilisation of natural light within the site, the use of a bright yellow sheer fabric above the space allocated for discussion and communication highlights the seating and therefore draws people in.

This is a core intention of the installation; **communication & discussion**.

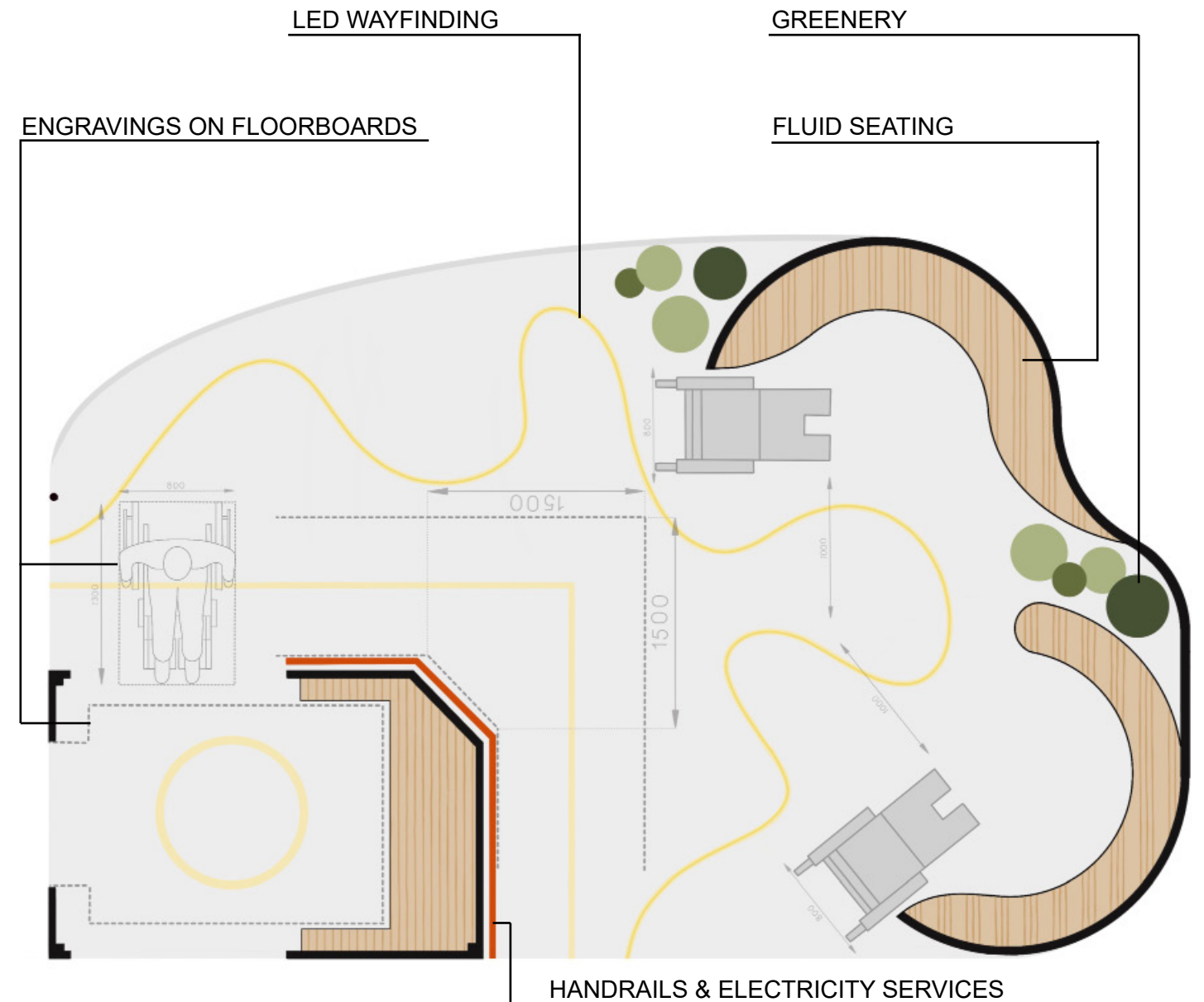

FLOORPLAN 1:50

Multiple images are layered over the floor area of this installation, whilst also incorporating different techniques of wayfinding and guidance.

To highlight AS 1428 minimum standards, diagrams are engraved on the floor below to educate the audience about the different ways these requirements can be utilised to **inspire fluidity rather than restrict it**.

LED's are utilised to promote wayfinding through a creative source. The intention of this installation is to inspire designers and the community to incorporate accessibility necessities in a fun and aesthetic way to promote the use of them, rather than the current avoidant attitude.

AS1428.6

CONTINUOUS ACCESSIBLE PATHS OF TRAVEL

AS1428.7

FLOOR OR GROUND SURFACES ON CONTINUOUS ACCESSIBLE PATHS OF TRAVEL AND CIRCULATION SPACES

AS1428.8

SIGNAGE

AS1428.9

TACTILE GROUND SURFACE INDICATORS (TGSIS)
PLEASE REFER TO DETAIL FLOORPLAN OF TGI'S

AS1428.12

HANDRAILS

AS1428.13

DOORWAYS, DOORS AND CIRCULATION SPACE AT DOORWAYS

AS1428.18

ASSEMBLY BUILDINGS

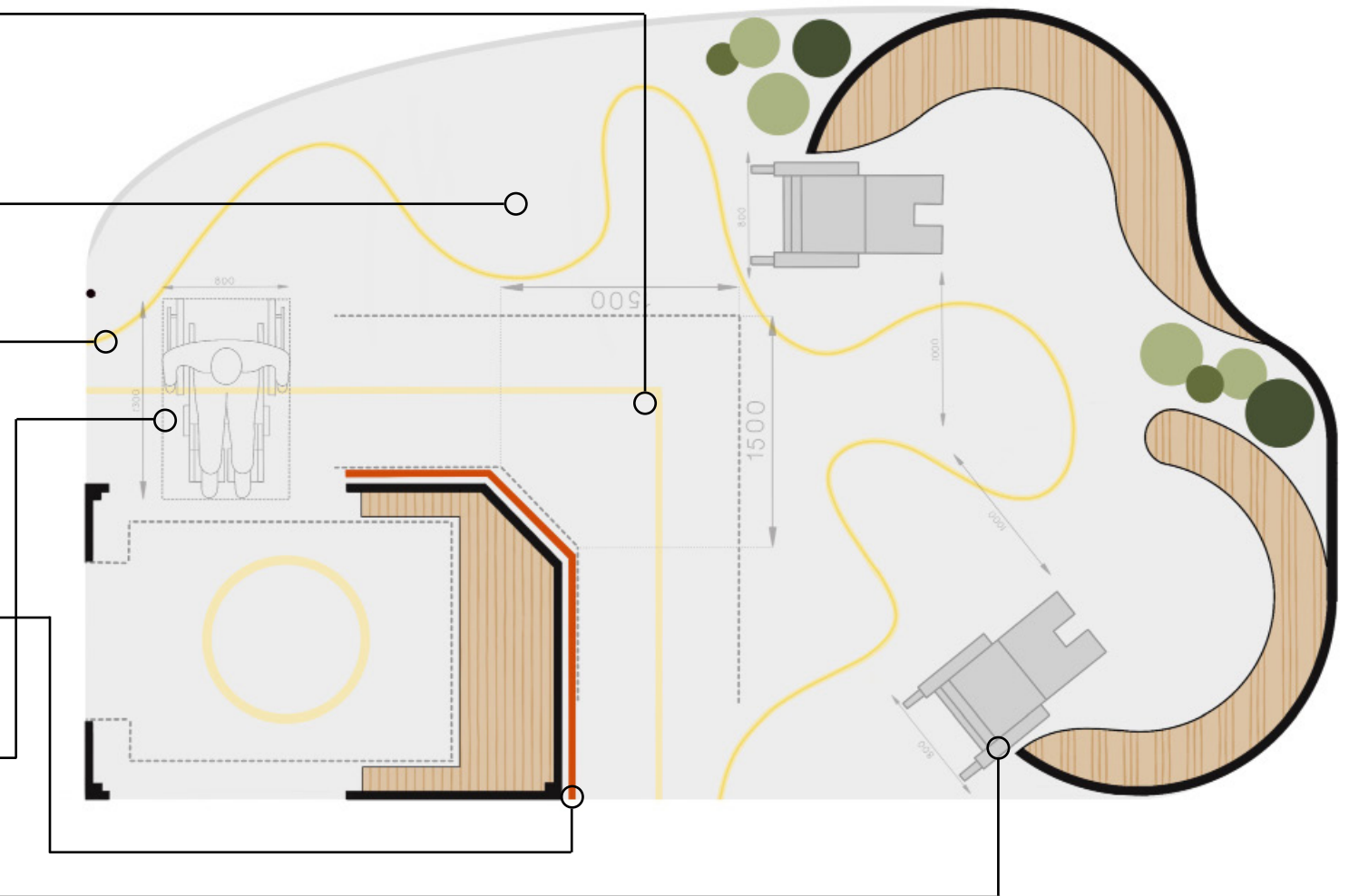

APPLICATION OF THE AUSTRALIAN STANDARDS WERE EXPLORED BY DYNAMICALLY ADJUSTING THE AVERAGE RESPONSE TO THE STANDARDS.

AS1428.6 GAVE DIRECT OUTLINES OF THE SPACE REQUIRED. BY INSERTING THESE IMAGES ON THE FLOOR, ONE CAN GATHER AN UNDERSTANDING OF THE SPACE OFFERED AS A MINIMUM, IN COMPARISON TO THE SPACE THAT COULD BE AFFORDED IF ACCESSIBILITY WAS CELEBRATED.

AS1428.8 SIGNAGE WAS A CORE ASPECT THAT WAS RE-EVALUATED. A FLUID PATTERN IS EXPLORED TO DIRECT AND ENCOURAGE INDIVIDUALS TO EXPLORE THE SPACE.

SIMILARLY, AS1428.18 ASSEMBLY BUILDINGS STANDARD PUSHED DESIGNERS TO RESTRICT WHEELCHAIR SEATING TO THE BACK OF AUDITORIUM, THEATRES, ETC. DUE TO THE SPACE REQUIRED FOR SAFE MOVEMENT. REINTERPRETATION OF THIS STANDARD HAS SEEN THE MOVEMENT OF THESE SEATS INTO THE CENTRE OF THE DISCUSSION SPACE, FURTHERMORE PUSHING THE CONVERSATION TOWARDS EXPERIENCE RATHER THAN OBSERVATION.

SECTIONS & ELEVATIONS

The materiality of this space accentuates that these standards are not limitations, but rather something that can be embraced

The intention behind creating a fluid space and playing with these translucent fabrics was to conceptually communicate the opportunity designers have to play around and explore these guidelines rather than meeting the minimum requirements.

As designers and as a society we should understand that accessibility goes beyond accessing the same, but rather incorporating a new perspective on design and its audience. The goal of this project is to inspire and ignite an interest in going beyond the 'accessible.'

It's not enough to simply follow these guidelines, we must embrace them to extend our designs.

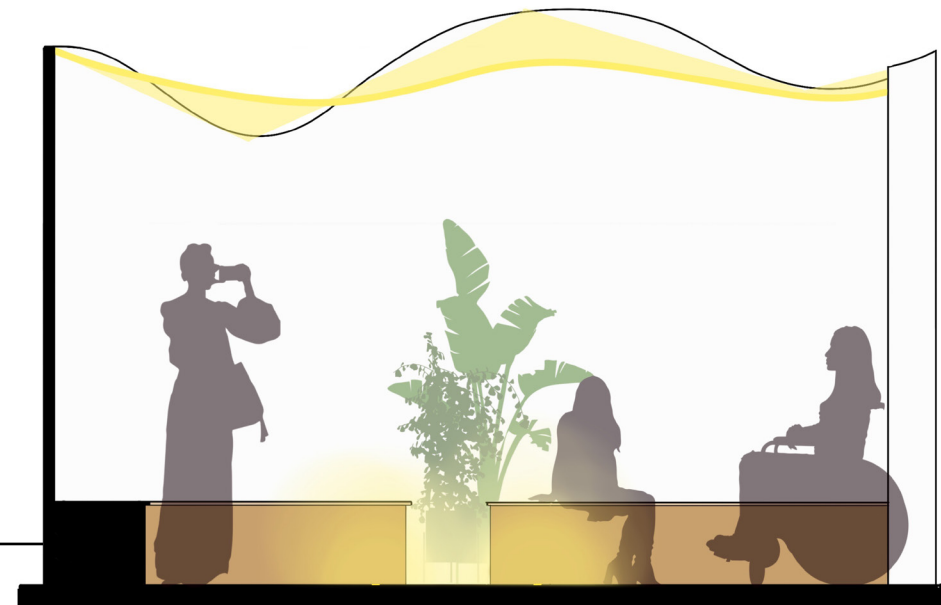
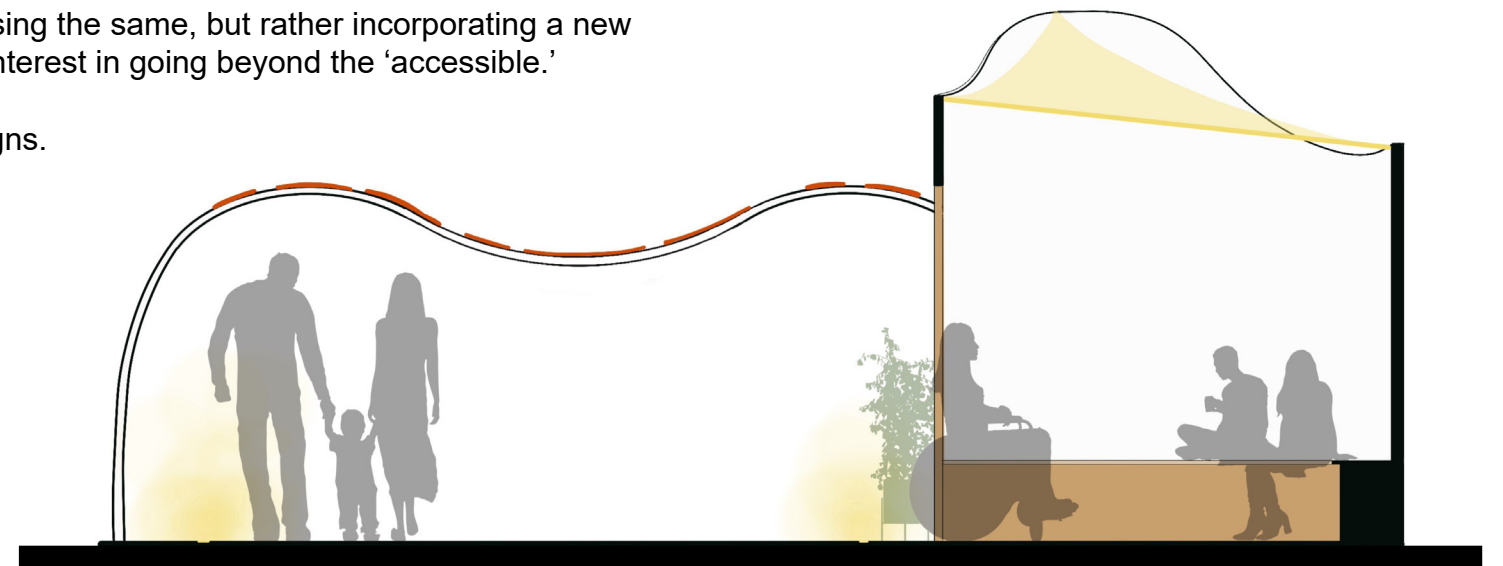
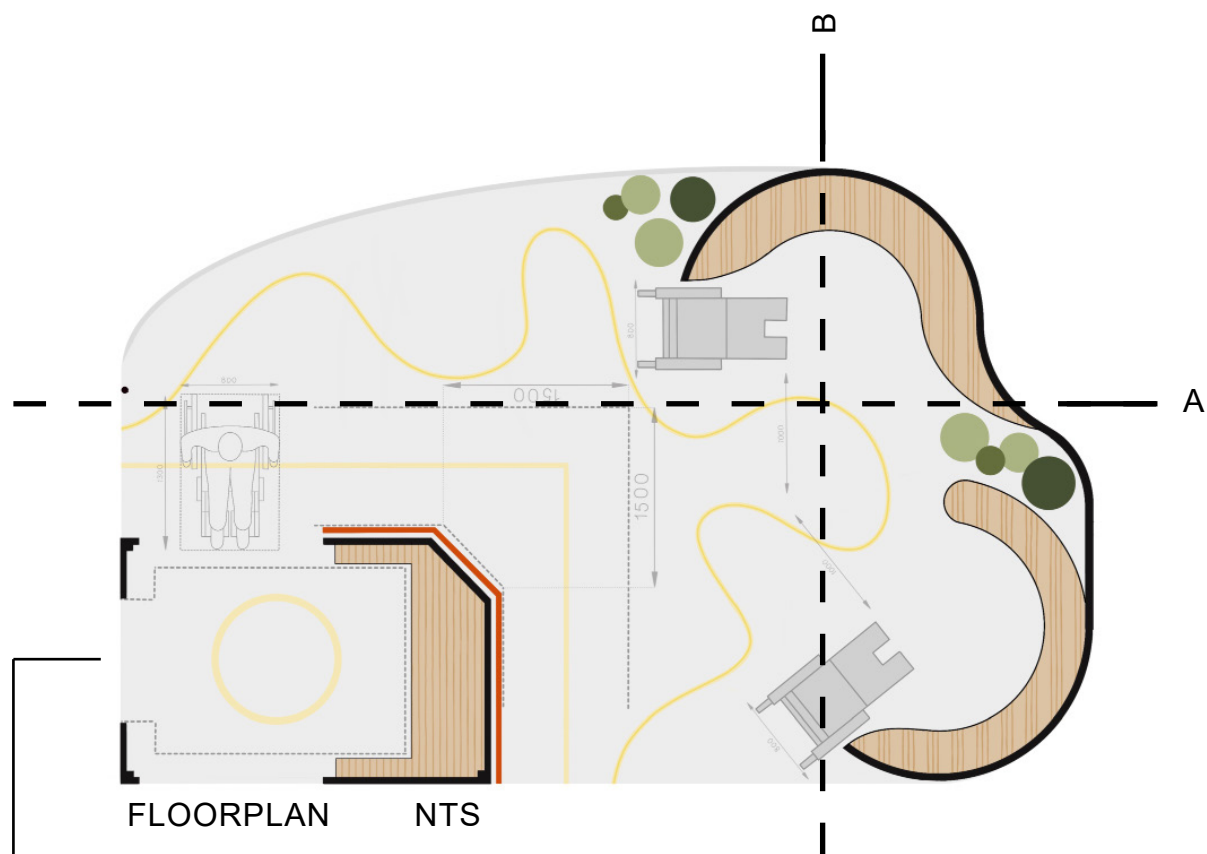

The storefront is continuously open to allow for audience members to appreciate the installation even when the store is closed. All stock and storage space is located within the seats that lift to reveal box storage below.

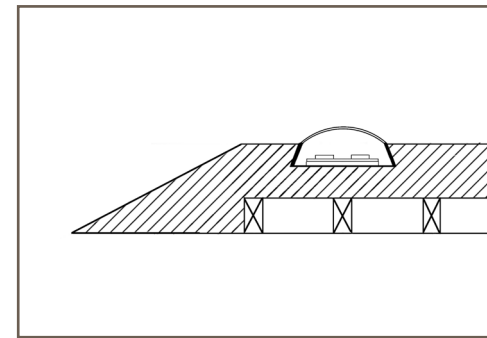
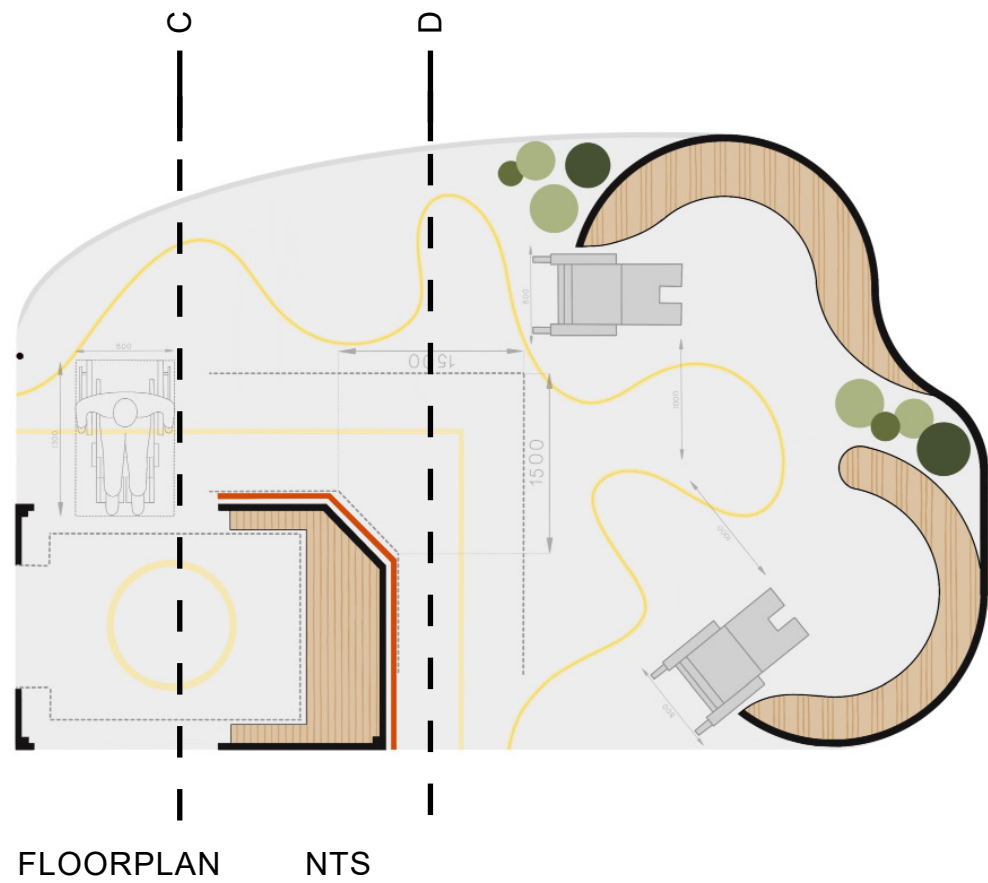

DETAIL SECTION OF LED CHANNELS & SURFACE ABUTMENT

1:5

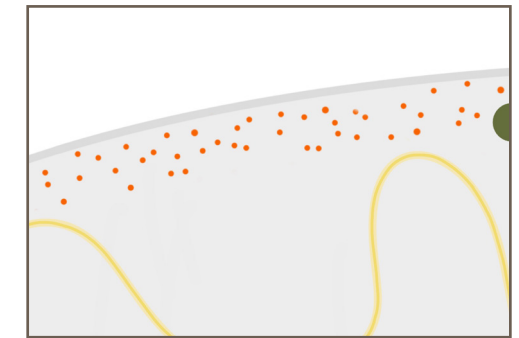

DETAIL FLOORPLAN OF TGI'S

1:50

Textured LED strip channels are utilised to create fluid wayfinding that is visually accessible from all points of the installation.

TGI's are also located around the boundary of the installation to signal a hazard (slight decline)

Texture's allow for compliance with AS1428.9 9 Tactile Ground Surface Indicators (TGSIs).

Installation is elevated only 50mm off of original flooring of the Watermall. A smooth transition is created to comply with AS1428.7.2 Construction Tolerances for Abutment of Surfaces

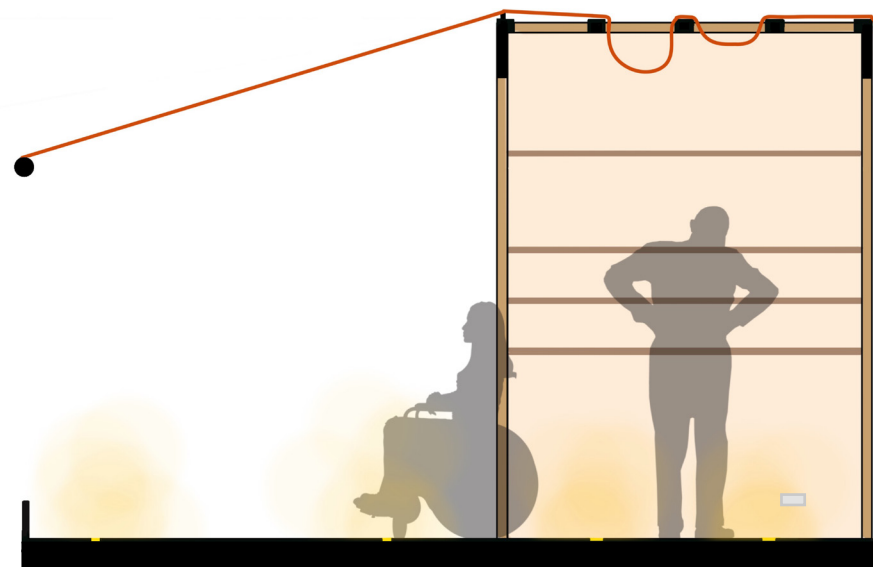

SECTION C 1:50

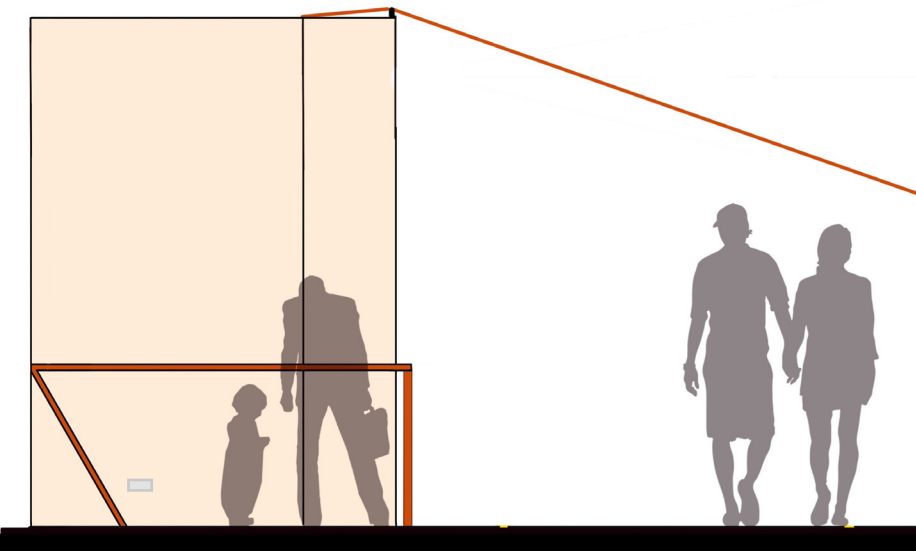

SECTION D 1:50

* Note varying heights of canopy bracing due to fluid bracing shape as shown in Section A

Section C depicts the store's shelving units, which will promote the purchase of Monte Lupu products. Section D allows for understanding of height spatiality, movement.

AS1428

IS ACCESS ENOUGH?

THE BUILDING CODE OF AUSTRALIA (BCA) AND THE DISABILITY STANDARDS (PREMISES STANDARDS), DEVELOPED THE AUSTRALIAN STANDARD TO ENSURE EQUAL ACCESS TO ALL BUILDINGS. THIS STANDARD IS LABELLED

AS1428

THE BUILDING CODE OF AUSTRALIA (BCA) AND THE DISABILITY STANDARDS (PREMISES STANDARDS), DEVELOPED THE AUSTRALIAN STANDARD TO ENSURE EQUAL ACCESS TO ALL BUILDINGS. THIS STANDARD IS LABELLED

THIS AUSTRALIAN STANDARD OUTLINES MINIMUM REQUIREMENTS FOR ACCESSIBILITY.

DESPITE THIS, MANY INDUSTRIES AND INDIVIDUALS ARE STILL STRUGGLING TO FEEL **INVITED & CELEBRATED** WITHIN SPACES.

THE BUILDING CODE OF AUSTRALIA (BCA) AND THE DISABILITY STANDARDS (PREMISES STANDARDS), DEVELOPED THE AUSTRALIAN STANDARD TO ENSURE EQUAL ACCESS TO ALL BUILDINGS. THIS STANDARD IS LABELLED

THE BUILDING CODE OF AUSTRALIA (BCA) AND THE DISABILITY STANDARDS (PREMISES STANDARDS), DEVELOPED THE AUSTRALIAN STANDARD TO ENSURE EQUAL ACCESS TO ALL BUILDINGS. THIS STANDARD IS LABELLED

EXPLORE THE FLUIDITY OF OUR OPTIONS

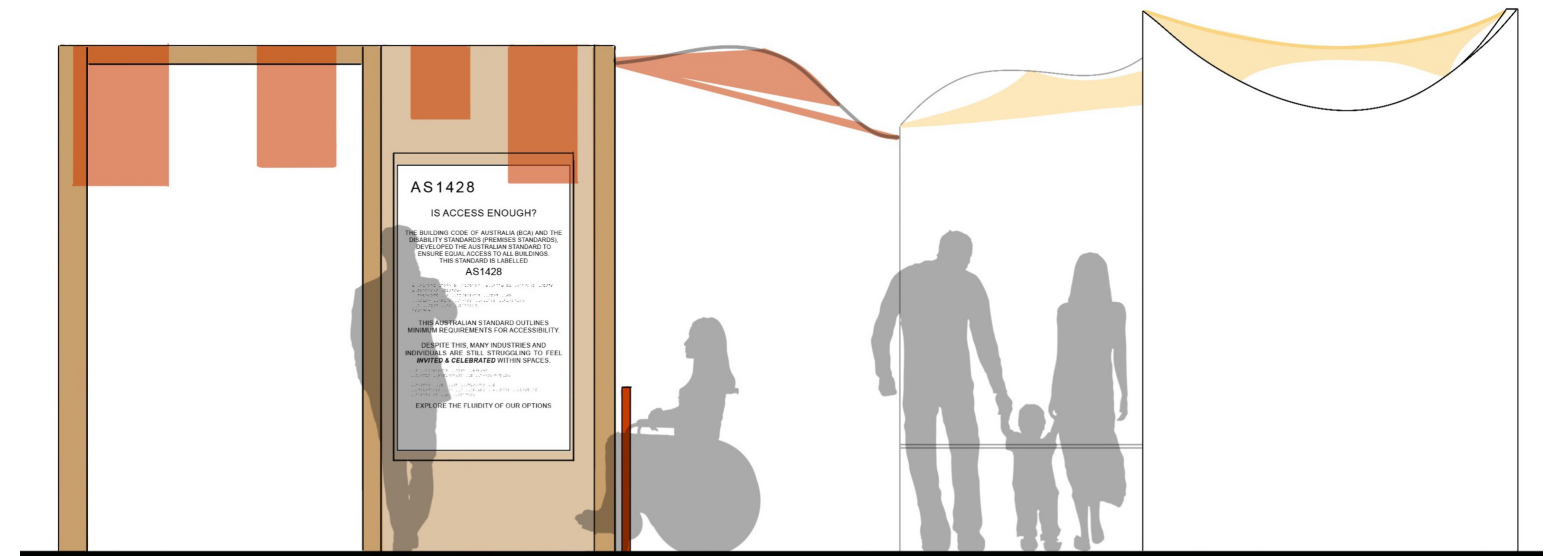

STORE ENTRY ELEVATION

1:50

THIS IS THE PROPOSED INSTALLATION INFOGRAPHIC DISPLAY WHICH WILL BE A PHYSICAL SIGN.

ENGRAVINGS AND **BRILLE TEXTS** WILL BE USED TO COMMUNICATE AND FURTHER THE INTENDED IMPACT OF AS 1428, AND BY DOING SO, WILL EXTEND AN UNDERSTANDING OF THE FUTURE POTENTIAL OF THE DESIGN INDUSTRY TO A WIDER AUDIENCE.

ALONGSIDE THE PHYSICAL TEXT OF THIS SIGNAGE, THE DISPLAY WILL BE ACCOMPANIED BY **TEXT-TO-SPEECH AUDIO** AND IS DISPLAYED IN AN **EASY TO READ FORMAT**.